

CSI***** GENEVE 2013



Class No. 10

Grand Prix Credit Suisse

Competition with one jump-off

vendredi 13 décembre 2013

Start: 19:00

Table: A
National RG:
FEI RG / Art. 238.2.2
Height: 1,55 m

Speed: 375 m/min
Length: 410 m
Time allowed: 66 sec
Time limit: 132 sec

Obstacles: 13
Efforts: 16
Penalty sec:
Closed combination:

1st Jump-off: 15-10-11b-3-4-5bc-7
Length: 270 m
Time allowed: 44 sec
Time limit: 88 sec

Course Designers: Gérard Lachat SUI
Luc Musette BEL
Assistant: Marco Cortinovis ITA

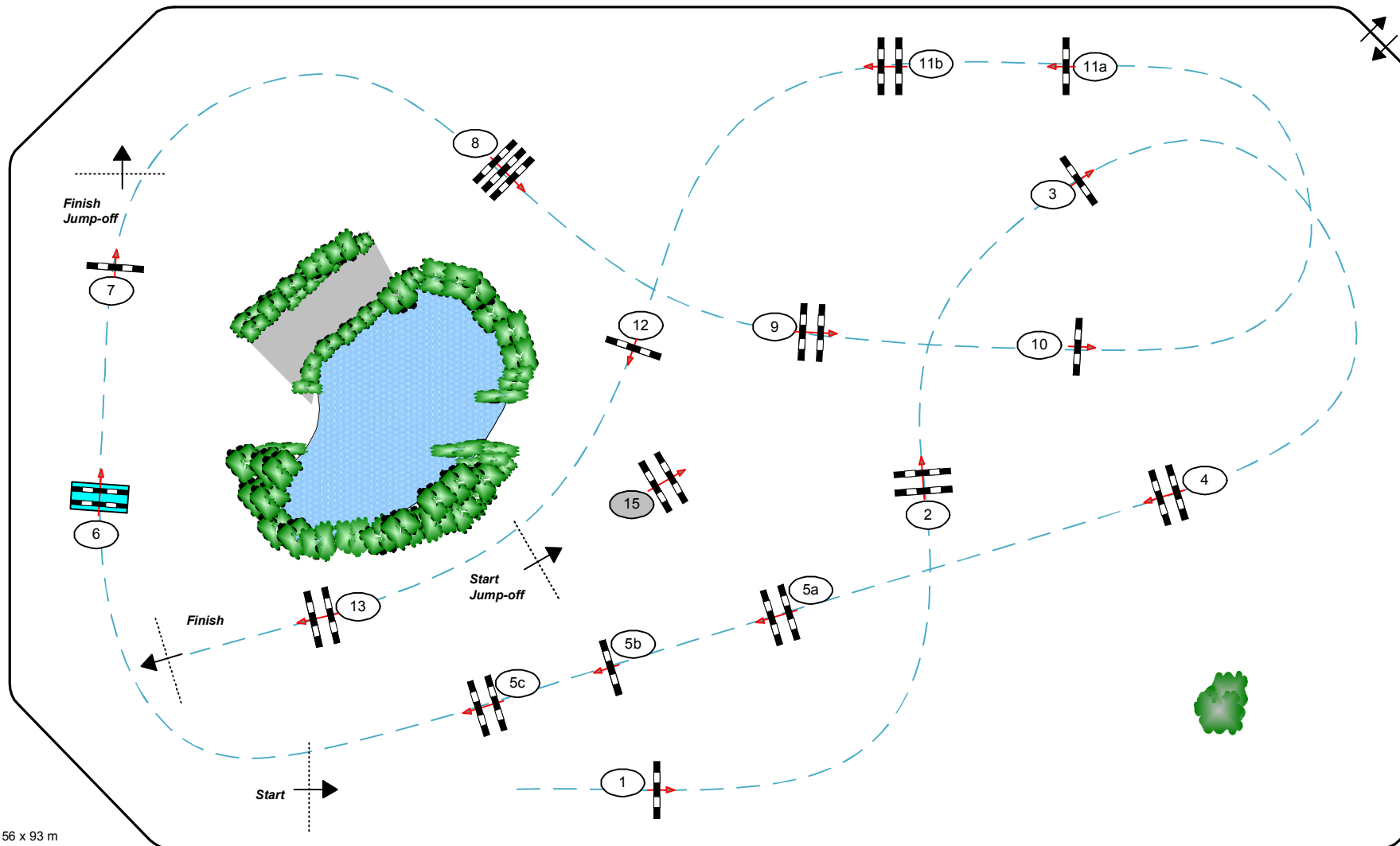

Arena: 56 x 93 m